

## MEGA SEG™ SYSTEM



- ultralight, double-sided, modular system
- **pre-assembled hinge-based construction = express unfolding**
- aluminium frame (4,2 cm)
- no tools assembly
- graphics mounted with silicone tape
- **several walls - one printout!**

The set includes: MEGA SEG system, a set of connectors (parallel - 4 pieces, top - 1 piece, bottom - 1 piece), transport bag.

- ultraleichtes, doppelseitiges, modulares System
- **vormontierte scharnierbasiertes Design = schnelles Entfaltungssystem**
- Aluminiumrahmen (4,2 cm)
- Montage ohne Werkzeug
- Silikonband montiert Ausdruck
- **mehrere Wände - ein Druck!**

Das Set enthält: MEGA SEG-System, Verbindungssatz (Serie - 4 Stück, oben - 1 Stück, unten - 1 Stück), Transporttasche.

- **pre-assemblée conception basée sur des charnières = système de dépliage rapide**
- système modulaire ultraléger, double face
- montage sans outils
- cadre en aluminium (4,2 cm)
- l'image montée à l'aide d'une bande silicone
- **plusieurs panneaux - une seule impression!**

Le kit comprend: un système MEGA SEG™, un jeu de connecteurs (série - 4 pièces, supérieur - 1 pièce, inférieur - 1 pièce), un sac de transport.

MEGA SEG SYSTEMS ARE DISTINGUISHED BY ITS PRE-ASSEMBLED DESIGN, WHICH SIMPLY NEEDS TO BE OPENED.

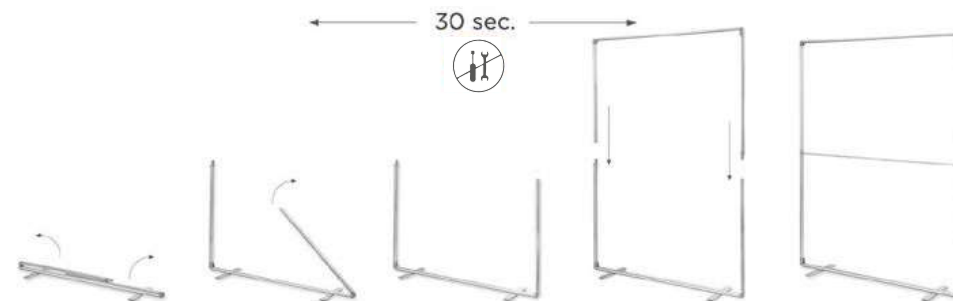

MEGA SEG SYSTEMS CAN BE CONNECTED TOGETHER USING SPECIAL CONNECTORS. THIS OFFERS ALMOST UNLIMITED POSSIBILITIES OF CREATING DIFFERENT SYSTEMS. CONNECTING THE PRODUCTS IN PARALLEL ALLOWS A SINGLE PRINT TO BE APPLIED, WITH NO VISIBLE GAPS BETWEEN THE SYSTEMS.

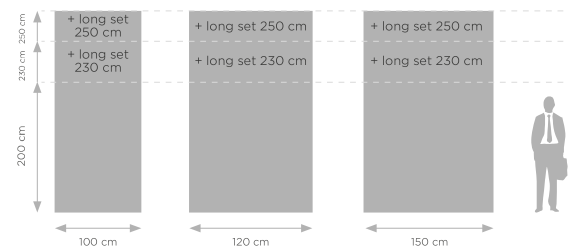

100x200	5907451668948	2,1 kg
120x200	5907451668931	2,6 kg
150x200	5907451668924	3,2 kg

Recommended media and printing technology for this system:



The Long Sets increase the height of the product up to 230 or 250 cm.